



## Mark your Calendar!

- 03/06 - Chamber After Hours at GSCF, 5-6:30 pm
- 03/07 - First Friday- David Petty, 4-6 pm
- **3/13 - Match Madness!**
- 04/01 - GSCF Spring Grants Open
- 04/04 - First Friday- Karla Prickett, 4-6pm

## George & Jeanne Frisbie's Legacy

Rick Frisbie is the best kind of person to visit with on a cold January day. While Salina was digging out from its largest snowstorm in more than 60 years, we had the opportunity to talk with Rick about his family and why they've chosen to utilize Greater Salina Community Foundation in their goal of honoring their parents' legacy of generosity in our area.

Jeanne and George Frisbie were parents to four children: Rick, Mike (deceased), Kris Frisbie-Jensen and Kathy Frisbie. The Frisbies owned a successful construction company in the area and lived their lives by doing

and giving what they could to help others. Rick shared that his parents were the kind of people who helped others clean up their basements after floods, complete basic chores, and welcomed those without a place to go for holiday dinners. In addition to helping individuals, the Frisbies collaborated with other families to take on larger projects that enriched the entire community.

### Honoring Their Parents

When George and Jeanne had both passed, their children wanted a way to see that their legacy of giving and helping continued. Rick said, "The

community foundation made it easy for us to set up funds that we knew would honor our parents and help ensure continued support for the things that were most important to them."

George and Jeanne were both very active in their congregation at Gypsum United Methodist Church. George had also been on the school board at USD 306 and was personally interested in seeing that students with potential, but lacking in financial resources, had the opportunity to continue their education. It made sense to Rick and

### INSIDE:

Page 1&2 - Feature Article

Page 3 - Gifts of Grain

Page 4&5 - News & Impact:  
Salina Grace & GSCF Nonprofit  
Award

Page 6- Match Madness

Page 7- Regional News

Page 8- Director's Message



GREATER SALINA  
**community  
foundation**

IMPACT TODAY. TRANSFORM TOMORROW.

# Frisbie Legacy (cont'd)

his siblings to create funds that would continue to support the congregation they grew up in, and to continue to support students from Southeast of Saline. To date, the scholarship fund has awarded \$30,750 to deserving students, while the fund to the church has provided \$12,843 in support. In addition to these funds, George and Jeanne's legacy lives on through a designated and field of interest fund that serve at-risk youth, and a donor advised fund overseen by Rick.

## Philanthropic Goals

Michael Chambers, GSCF's Vice President of Community Impact said, "The first George and Jeanne Frisbie Family fund was established in 2008 and the most recent was established in 2024. The goal of the Foundation all along has been to align the appropriate fund type with the

Frisbie's philanthropic goal to help others while honoring their parents' giving and generous spirits."

Rick said, "My parents provided my siblings and me with a great example of caring for our neighbors and others in need. Our relationship with the Greater Salina Community Foundation has allowed us to do that in a way that lets us respond to immediate needs in the community and set out resources that will benefit this community long after we're gone. We feel like that is the best way to honor our parents."



George and Jeanne Frisbie



**The Community Foundation made it easy for us to set up funds that we knew would honor our parents and help ensure continued support for the things that were most important to them." ~ Rick Frisbie**

## Give Back 5 Surpasses Halfway Mark!

We are thrilled to announce that the Give Back 5 Community Giving Pledge campaign has surpassed the halfway mark toward its goal of securing 125 pledges by June 30, 2025. To date, 70 individuals have pledged to donate at least 5% of their retirement or other investment accounts to local nonprofits, ensuring long-term support for vital community services.

"We are incredibly encouraged by the generosity and commitment of our community members," said Jessica Martin, President & Executive Director. "Surpassing the halfway mark is a significant milestone and we are hopeful that more people will take the pledge to help us reach our goal. This campaign is an opportunity

to benefit local nonprofits and strengthen our community for future generations."

### Empowering Future of Nonprofits

Last year, over \$13 million was granted to local charities and projects through funds held at the Community Foundation. Planned gifts, such as those pledged through the Give Back 5 campaign, allow nonprofits to focus on their missions with confidence, knowing they have sustainable financial support.

"We are often asked by our donors, how can we help meet your immediate needs, but we are rarely asked how can we help you sustain your operation for the long-term," said Karen Couch, Executive Director

of the Salina Emergency Aid Food Bank. "The Give Back 5 Campaign gives us the opportunity to have that conversation with donors and volunteers, helping us make sure that we are here for years to come."

### Engaging the Next Generation

Give Back 5 is also engaging the next generation of donors with 31 pledges representing Gen X, Millennials and Gen Z donors.

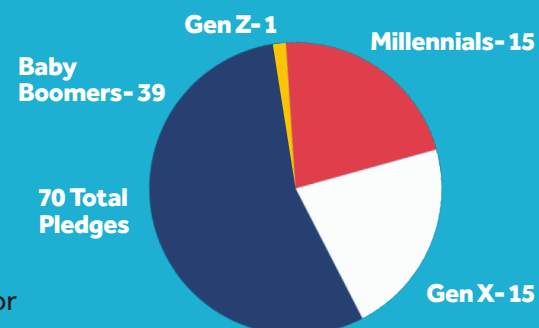

# Gifts of Grain

Making a gift of grain is an easy way for farmers to make an impact in their community, while also avoiding income tax.

Most of us think of charitable contributions as what we give in cash. However, if you are a farmer, donating grain can be a more effective way to support your community or favorite charity.

By gifting bushels instead of the cash proceeds from a sale, you can maximize your impact while benefiting from key tax advantages:

- The value of the donated grain is not included on Schedule F.
- Expenses related to producing the grain remain deductible in the year paid.
- Federal, state, and self-employment tax are not owed on the donated grain.
- Your yield records remain unchanged, preserving your historical production data/baseline.
- Since no income is recognized, there is no charitable deduction for the gift.



## How to Donate Grain to the Community Foundation

Giving grain is simple! When delivering your crop to the grain buyer, specify the number of bushels you wish to donate to the Greater Salina Community Foundation. The grain buyer will then notify GSCF and we will instruct them to sell it. After the grain is sold, we will deposit the proceeds into the fund of your choice.

**Key Reminder:** To ensure the tax benefits, the donation must be made **before** the grain is sold.



**Jacob Yarochowicz, Nex-Gen Donor  
Wealth Manager, BE Wealth**

**“I joined the Give Back 5 Pledge because I see first-hand how impactful charitable giving can be for individuals and communities. Committing 5% of your retirement assets to charity is a way of ensuring that the causes you care about continue to make an impact.”**

**Take the pledge now to join Jacob and others in the community at [www.giveback5.org](http://www.giveback5.org) or scan the QR code**



## Join Others!

Adrienne Allen  
Jim Allen  
Danielle Brown  
Eric Brown  
Michael Chambers  
Beverly Cole  
Dale Cole  
Doyle Comfort  
Maureen Comfort  
Brandon Ebert  
Heather Ebert  
Karen Ebert  
Ken Ebert  
Kelli Exline  
Rob Exline  
Rick Frisbie  
Mark A. Gruenthal  
Maggie Hemmer  
Tom Hemmer  
Jenell Hulse  
Phyllis Johnson  
Cathy Krug  
Randy Krug  
Pilar LaPointe

## Current Pledge List (02.14.25)

Jim Loader  
Jerry Lonergan  
Nancy Lonergan  
Aaron Martin  
Dave Martin  
Jessica Martin  
Casey McCoy  
Melissa McCoy  
Bill Medina  
Jake Mitchell  
John Mize  
Karen Mize  
Patrik Neustrom  
Rita Northup  
Dennis Oakes  
Martha Oakes  
J.J. O'Connor  
Tammy O'Connor  
Bob Peck  
Cindy Peck  
Pete Peterson  
Rita Peterson  
Katie Platten  
Tom Platten  
Brianna Quinley  
John Quinley  
Kevin Quinley  
Mary Quinley  
Jon Ramsey  
Sharlene Ramsey  
Martha Rhea  
Mark Ritter  
Abbey Rupe  
Chris Rupe  
Matt Shaffer  
Rita Shaffer  
David Simmons  
Mac Steele  
Aaron Wedel  
Carolyn Wedel  
David Wedel  
Mark Wedel  
Sarah Wedel  
Jacob Yarochowicz  
Loren Young  
Sara Young

# NEWS & Impact

## Salina Grace Community Resource Center

December 2024 - \$10,000 GSCF Winter Grant Cycle

Salina Grace Community Resource Center remains committed to removing barriers and providing opportunities for our homeless neighbors to transition off the streets and receive the help they need. Through partnerships with local nonprofits, including People in Need (P.I.N.), Central Kansas Mental Health Center, and Salina Family Healthcare Center, Salina Grace offers essential services to support stability and recover.

Since relocating to 315 S. Broadway Blvd., Salina Grace has served 803 individuals including 72 veterans. Additionally, the center operates a Winter Shelter from November 15-March 15, providing shelter for approximately 30 individuals each night through a referral-based program.

### Partnering with Salina Shares

To further its mission, Salina Grace is renovating its Community Resource Center to include showers, laundry facilities, and a clothing room. This is in collaboration of agencies, such

as Salina Shares, who generously purchased an industrial-sized washer and dryer for the facility. The laundry services and shower sign-ups will be managed by volunteers. "These upgrades will restore dignity, improve hygiene, and offer a foundation for recovery as we help people get off the streets and back on their feet," said Chad Young, Executive Director.

This project also received a \$10,000 grant from the Greater Salina Community Foundation's winter grant cycle through two different funds- \$9,500 from the Dane G. Hansen Community Grant Fund and \$500 from a donor advised fund.

"It's inspiring to see donor advised fundholders and funds through the GSCF grant cycle come together to support impactful projects like this," said Jessica Fuller, Director of Grants & Scholarships.

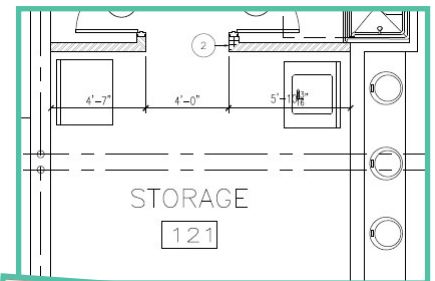

**These upgrades will restore dignity, improve hygiene, and offer a foundation for recovery."**  
~ Chad Young, Executive Director, Salina Grace



"Local nonprofits can apply to our Spring Grant Cycle by visiting our website at [www.gscf.org/grants](http://www.gscf.org/grants). Our Spring Grant Cycle opens April 1 and is due May 15. Please feel free to reach out if you have any questions."

~Jessica Fuller, Director of Grants & Scholarships

# GSCF Receives Outstanding Foundation Award

The Greater Salina Community Foundation received the “2024 Outstanding Foundation Award” as part of AFP Kansas Heartland’s National Philanthropy Day Awards. National Philanthropy Day is a special day set aside to recognize and pay tribute to the great contributions that philanthropy—and those people active in the philanthropic community—have made to our lives, our communities and our world.

“Working with people at the Foundation who are making a difference in our communities is a reward in itself,” said Jessica Martin, President & Executive Director. “To have someone else recognize the work that is happening here is wonderful and also very humbling.”

The outstanding foundation award is presented to a private foundation (company or family) that has demonstrated outstanding commitment to the community through financial support. The recipient of this award encourages and motivates others to take leadership roles toward philanthropy with national, international and/or community involvement.

Greater Salina Community Foundation was selected for this

award based on its philanthropic work through Match Madness, specifically cultivating the next generation of givers with Saline County 5th graders. Last year, over \$1.1M was raised on March 21, 2024, to benefit 100 local nonprofit organizations and causes. With the support of generous donors, 634 Saline County 5th graders were also given the opportunity to contribute \$10 to any participating nonprofit of their choosing and have it matched up to 50%. Since 2012, nearly \$6M has been raised for 106 local nonprofits and organizations.

“To everyone who has helped make Match Madness and the Foundation a success- thank you! This award is also for you,” said Martin.

For a complete list of AFP National Philanthropy Day honorees, go to [www.afpkansasheartland.com](http://www.afpkansasheartland.com)



## New GSCF Funds (established 10/16/24-02/14/25)

- Boys & Girls Club of Salina Fund
- Brookville Fire Station Fund
- Todd and Tara Herrenbruck Family Fund
- John & Gig Jones Fund
- Salina Presbyterian Manor Fund
- David Wedel Family Fund

### Funds for the Future:

- Brown Family Fund
- J.J. and Tammy O'Connor Fund

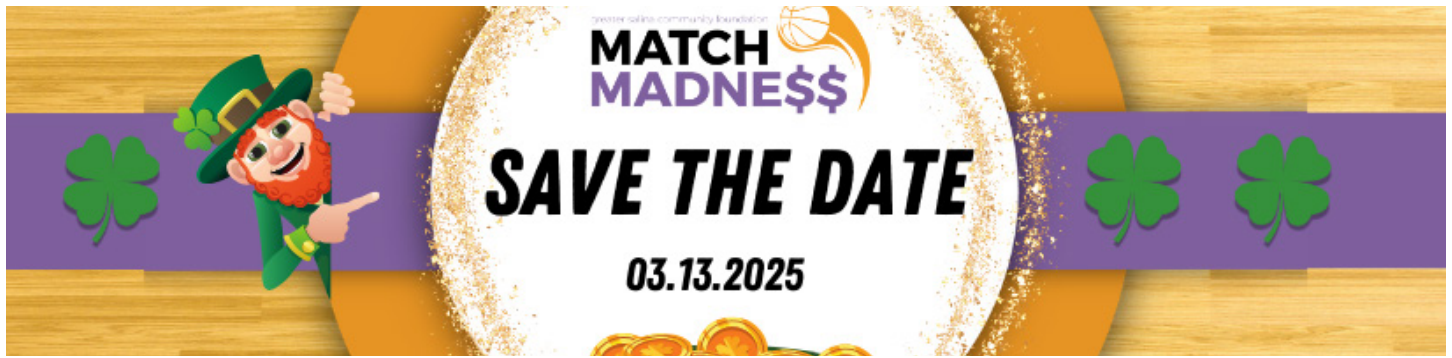

## Record Number of Nonprofits Participating in Match Madness!

With “a bit of luck” and generosity, Match Madness 2025 is gearing up to be the biggest yet, with a record-breaking 103 nonprofit organizations participating. Now in its 14th year, the annual giving event will take place on Thursday, March 13, at the Salina Fieldhouse from 7 am to 6 pm.

“This is the highest number of nonprofits we’ve ever had at Match Madness,” said Jessica Martin, President & Executive Director. “It’s incredible that a community our size actively supports so many organizations. We are truly fortunate to live in such a generous and giving place!”

### How Does it Work?

All donations made on March 13 will be matched up to 50% by a \$300,000 match pool. The donations are deposited into each nonprofit’s permanent endowed fund held at the Foundation for long-term support and the matching dollars are awarded in the form of an instant-cash grant to meet immediate needs. It’s a win-win!

Donors can give three different ways: 1) In person from 7 am to 6 pm at the Salina Fieldhouse; 2) Online at [www.matchmadnessgscf.org](http://www.matchmadnessgscf.org) from midnight to 11:59 pm; and

3) Mail donations postmarked by March 13 to GSCF, PO Box 2876, Salina, KS 67402-2876.

In addition to taking in donations that day, there will be lots of activity taking place on the basketball courts with the popular Bill Grevas Minute to Win It Free Throw Contest sponsored by Bennington State Bank, as well as the Half Court Shot Contest sponsored by BE Wealth.

“Match Madness has something for everyone,” said Michael Chambers, VP of Community Development. “We’ll have food trucks and snacks throughout the day, and you won’t want to miss the nonprofits showing off their basketball skills for a chance to win extra money.”

### Teaching the Next Generation

All Saline County 5th graders will also attend Match Madness for the third year in a row, with \$10 each that they can contribute to any nonprofit of their choice. When asked why this event is important, a 5th grade teacher said, “We can’t teach this. This is something that the students have to experience, and anytime we can let a student have an experience outside of the classroom, it’s a home run!”

**Go to [www.matchmadnessgscf.org](http://www.matchmadnessgscf.org) to learn more.**

## Connecting with Our Community

Over the last few months, the Community Impact Team has been intentional about meeting individually with folks in our community with connections to the Greater Salina Community Foundation. We’ve added a Mission Moment to our board meetings which gives nonprofit organizations an opportunity to share their mission directly with our board of directors.

We’ve also been interviewing fundholders, board members and community leaders to catalog their GSCF stories. It’s an absolute privilege to be able to sit down with someone who is willing to talk about their

relationship to GSCF and expand upon their “why” for being involved. Everyone has a unique story and a personal reason for being involved. We’d love to hear from you too. Please join us at the Salina Fieldhouse for Match Madness or drop by one of our First Friday events

Thank you for your continued support of GSCF!

~Michael Chambers,  
VP of Community Impact



# In the Region

## Heartland Community Foundation Director Sarah Meitner Recognized as Rural Innovator at the White House

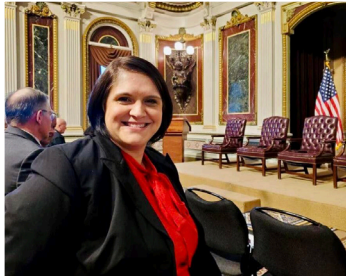

Sarah Meitner, Executive Director of the Heartland Community Foundation in Hays, was honored as one of 14 Rural Innovators recognized by the White House for their outstanding contributions to rural communities across the United States. Sarah was the sole Kansan selected for this distinction and participated in the White House Rural Innovators Initiative event on December 18, 2024, where she highlighted the impactful work happening in Northwest Kansas.

Sarah was celebrated for her leadership in creating inclusive spaces, fostering a culture of charitable giving, and supporting local nonprofits. Central to her nomination was her work on the Hays ARC Park, a \$2.1 million inclusive playground and splash pad. Inspired by her son Abe who has Down Syndrome, the ARC Park provides a space where children and families of all abilities can play together.

“It was absolutely the coolest experience,” said Sarah of the White House event. “I was honored to represent Kansas and share the incredible stories of perseverance, humility, and collaboration from our Heartland communities. While I didn’t feel worthy, I realized the collective work we’re doing together truly makes a difference.”

## Regional Match Opportunities

Thanks to the generosity of the Dane G. Hansen Foundation and Patterson Family Foundations, our region has no shortage of matching dollar opportunities.

- **Dane G. Hansen Foundation:** 2:1 match up to \$50,000 for donations to unrestricted funds.
- **Patterson Family Foundation:** 1:1 match up to \$70,000 for donations to most funds.

## Upcoming Matching Events

- **February:** Heartland Community Foundation (Ellis, Rooks & Trego Counties), Post Rock Community Foundation (Lincoln County)
- **March:** Jewell County Community Foundation
- **April:** Ottawa County Community Foundation, Solomon Valley Community Foundation (Mitchell County)
- **May:** Republic County Community Foundation, Washington County Community Foundation

**Note: Each match event is different.** Some are available the entire month and some are one-day only. See affiliate websites and Facebook pages for more info.

Since October 2024, our affiliates have leveraged over \$790,000 in matching funds from the Dane G. Hansen Foundation and Patterson Family Foundation. **Fun Fact: Republic County received 4 gifts of grain during their match month, totaling \$6,205.44!**

## New Regional Staff- Welcome Aboard!



Post Rock Community Foundation hired their first Coordinator, Elisa Agler. Elisa’s position is funded in part by a grant from the Dane G. Hansen Foundation.



**Serving 10 regional affiliates and 13 counties throughout north central and western Kansas.**



GREATER SALINA

community  
foundation

PO Box 2876 • 119 W. Iron Ave., 8th Floor  
Salina, KS 67402-2876

## BOARD OF DIRECTORS

<b>Maggie Hemmer,</b> Board Chair	Kelly Brown
<b>John Quinley,</b> Past Chair, Community Impact Committee Chair	Brandon Cheeks
<b>Kathy Schwerdtfager,</b> Vice-Chair	Doyle Comfort
<b>Ryan Commerford,</b> Treasurer, Finance Committee Chair	Lindsay Garber
<b>Dr. Rob Freelove,</b> Secretary	Julie Goetz
<b>Karen Black,</b> Grants & Scholarships Committee Chair	Bryan Herwig
	Josh Howard
	Denice Justus
	Mark Palen
	Bailey Ramsey
	Jon Ramsey
	David Wedel

## FOUNDATION STAFF

<b>Jessica Martin,</b> President & Executive Director	<b>Jessica Fuller,</b> Director of Grants & Scholarships
<b>Michael Chambers,</b> VP of Community Impact	<b>Natalie Wood,</b> Affiliate Relations & Grants Coordinator
<b>Rita Northup,</b> Executive Assistant	<b>Julia Diaz,</b> Community Impact Team Assistant
<b>Brandee Mayginnes,</b> Director of Operations	<b>Leah Wilson,</b> Marketing & Communications Coord.
<b>Kristin Blake,</b> Director of Finance	
<b>Shanna King,</b> Staff Accountant	

# Director's Message

Some might say we have the best view in town because our office is on the 8th floor of the United Building... and they have a good point! But I would argue that the best view in town, is the generosity that our staff gets to witness every day—donors and nonprofits **working together to make a mark** in our community and in the lives of others. Here are just a few examples of “the view” from our office:



- Salina Grace **making a mark** by providing critical services to our homeless neighbors through their community resource center.
- Jacob Yarochowicz, a Nex-Gen donor **making a mark** by taking the Give Back 5 Community Giving Pledge ensuring the causes he cares about will continue to make an impact in the future.
- George and Jeanne Frisbie **making a mark** in their hometown Gypsum, and by helping those less fortunate through permanent funds set up in their names by their children.

**What do you want your mark to be?** Impact Today. Transform Tomorrow!

Jessica L. Martin  
President & Executive Director

**Our mission is to build permanent endowment funds and meet charitable community needs.**